



RHINO UK

making sense of senses

Rhino UK

Design & Installation Guide

2024

Get In Touch

 www.rhinouk.com

 01270 766660

 sales@rhinouk.com



Rhino UK About Us

Making Sense of Sensory

At Rhino UK, we're passionate about crafting accessible sensory spaces that support, uplift and transform lives.

Our friendly sensory team has over **75 years** of combined specialist sensory knowledge and experience. From enquiry through to your fully finished sensory space - they'll be on hand to guide, support, and manage your sensory journey.

We'll always strive to put your needs and budget at the centre of our plans, and because of this, our sensory installation process is highly collaborative.

Did you know that our passion for sensory doesn't stop at rooms? We also offer a range of portable, interactive and developmental sensory resources to complement all budgets and environments - so that you can support your senses fully!

At Rhino UK, we're proud to make sense of senses.

How can we help?

Every Sensory Room is unique. You'll never find two of the same. We like to work closely with parents, carers and healthcare professionals to craft bespoke spaces that meet individual needs, including;

- Sensory Processing Disorders
- Cerebral Palsy
- Communication Skills
- Dementia and Alzheimer's
- Autism
- Reminiscence
- Rehabilitation
- Visual Impairments

With you every step of the way

- Free design and planning service
- Free on-site demonstrations and product training
- Bespoke maintenance packages
- Value for money
- Ongoing support from our friendly sensory team

About Us Why Choose Rhino?

We strive to go the extra mile with our designs, installations and customer service to provide complete customer satisfaction and the very best sensory experiences.

Discover what our customers have to say by reading the testimonials below.

“ The Sensory Room is brilliant and provides a variety of sensory experiences. I have received some magnificent feedback from our staff, professionals, children and parents. The installation was stress-free and very professional, and all equipment is high quality. I would certainly recommend your services to other Children's Centres!”

Linda Dunn, Outreach Manager, Kingsland Centre



“ We've had our sensory room for two years now and it's still as good as new, even though we use the room everyday! It's so versatile; we can use it for quiet sessions and energetic play. The children really love it and benefit from the space in their own individual way. Rhino's after sales service has also been second to none. Thank you once again.”

S Harpur, Play Co-Ordinator, Chesterfield Hospital

“ My experience with Rhino UK has been excellent, I would wholeheartedly recommend them to anyone wanting a quality sensory room. The Rhino team has a friendly, hands-on attitude and nothing is too much trouble for them. I am confident that we'll return to Rhino in the future when we're ready to develop our room further. Thank you so much!”

L Barrow, Manager, Middlewich Children's Centre



Our Accreditations



Constructionline
Gold Certified



CSCS
Accredited
Installation Team



Acclaim
SIIP
Accredited

Approved Supply Networks



CPC Education Framework



Education Play Equipment

Our Sensory Rooms

Multi-Sensory Rooms

A Multi-Sensory Room is a dedicated space for therapeutic development and sensory play. Filled with a collection of light, sound, and tactile effects, Multi-Sensory Rooms are environments where users, young and old, can explore their senses and emotions safely.

Away from outside distractions, these immersive environments offer the opportunity for inclusive lessons, one-on-one therapy sessions and the time and space to develop key skills such as fine and gross motor, cause and effect, and hand-eye coordination.

Popular Multi-Sensory Room Products

Bubble Tubes



Fibre Optics



Interactive Projector



Safety Padding



Benefits of Multi-Sensory Rooms

- Stimulates visual, tactile, audio, proprioceptive and vestibular senses
- Improves co-ordination and motor development
- Promotes cognitive development
- Develops communication and social skills
- Boosts physical and mental wellbeing

Where do Multi-Sensory Rooms work best?

- Schools
- Hospitals
- Community Centres
- Public Spaces - Airports, Leisure Centres, Shopping Centres, Football Clubs
- Private Houses

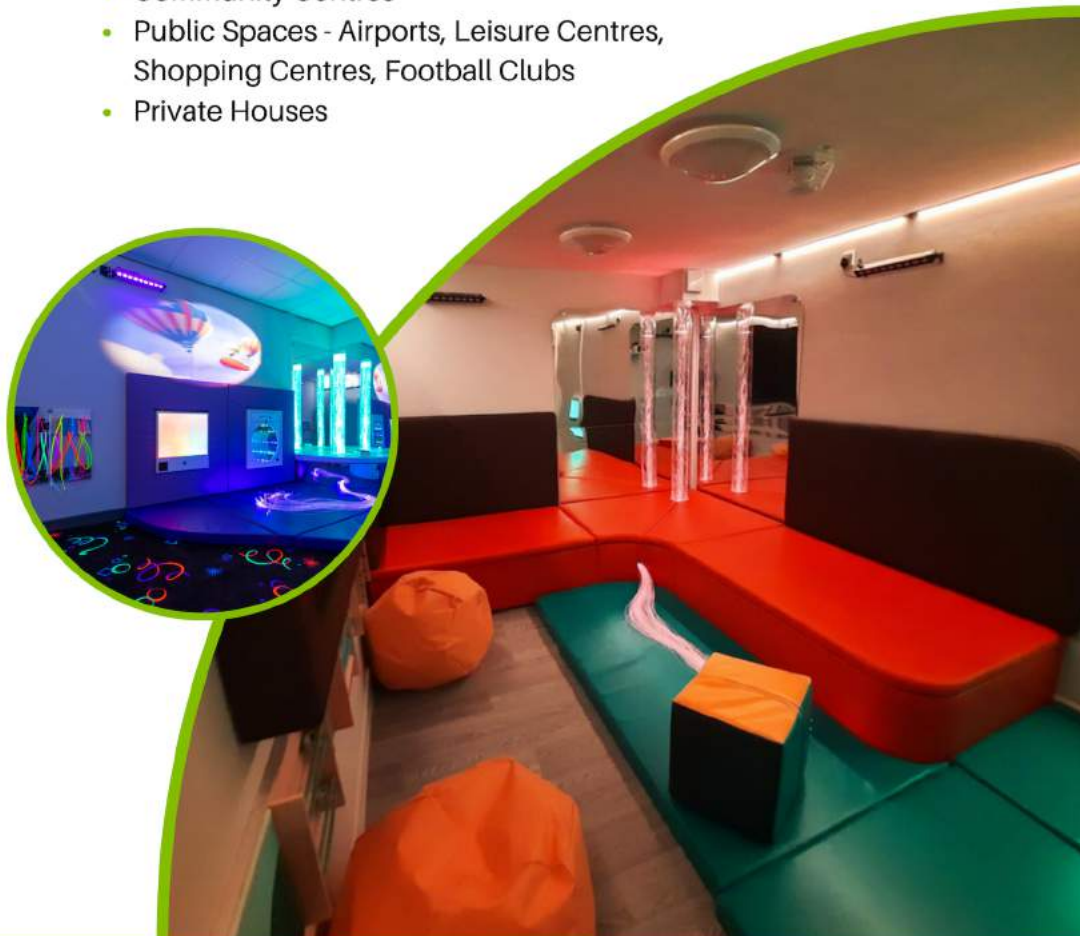

Orchard Brea Nursery

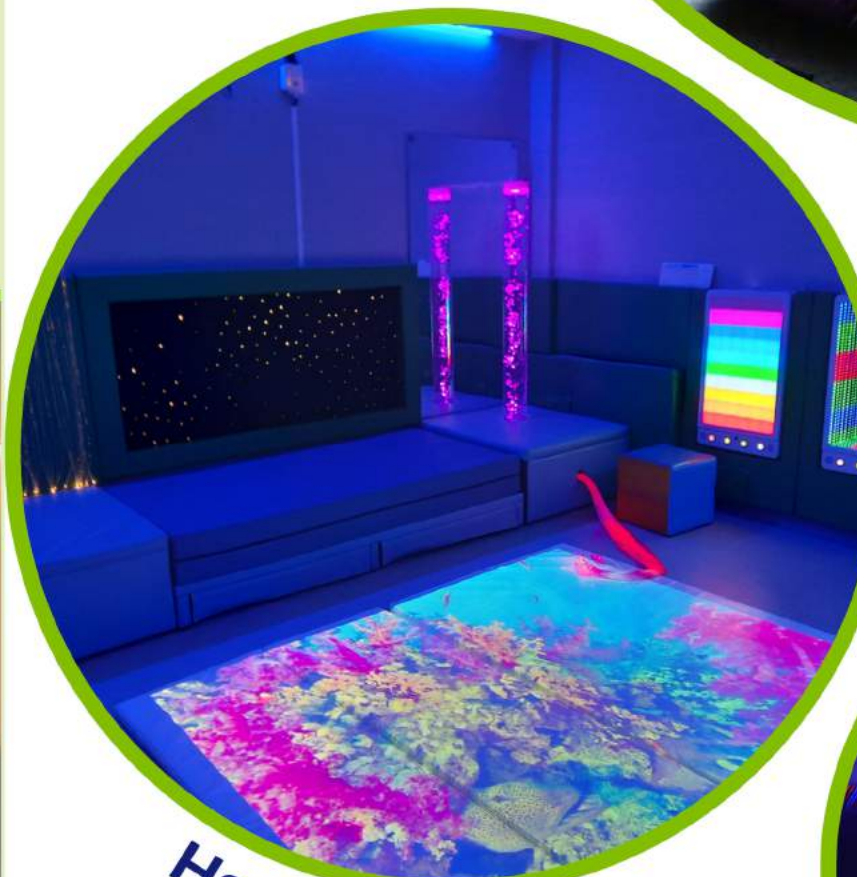

Harlow Academy

Sir Tom Finney High School



Our Sensory Rooms

Sensory Integration

Used by Occupational Therapists (OTs) and Physiotherapists, Sensory Integration Rooms are therapeutic spaces dedicated to the development of Vestibular and Proprioceptive senses.

These technical rooms are filled with specialist equipment designed to develop users balance, mobility, bodily awareness and confidence, including swings and suspension systems, soft padding for walls and floors, ball pools & rockers.

Popular Sensory Integration Room Products

Beam Frame



Platform Swing



Climbing Wall



Safety Padding



Benefits of Sensory Integration Rooms

- Stimulates vestibular and proprioceptive senses
- Improves motor development
- Enhances daily function and learning ability
- Regulates sensory stimulation
- Develops positive behaviour patterns

Where do Sensory Integration Rooms work best?

- Schools
- Gyms & Physiotherapy Centres
- Community Centres
- Private Houses

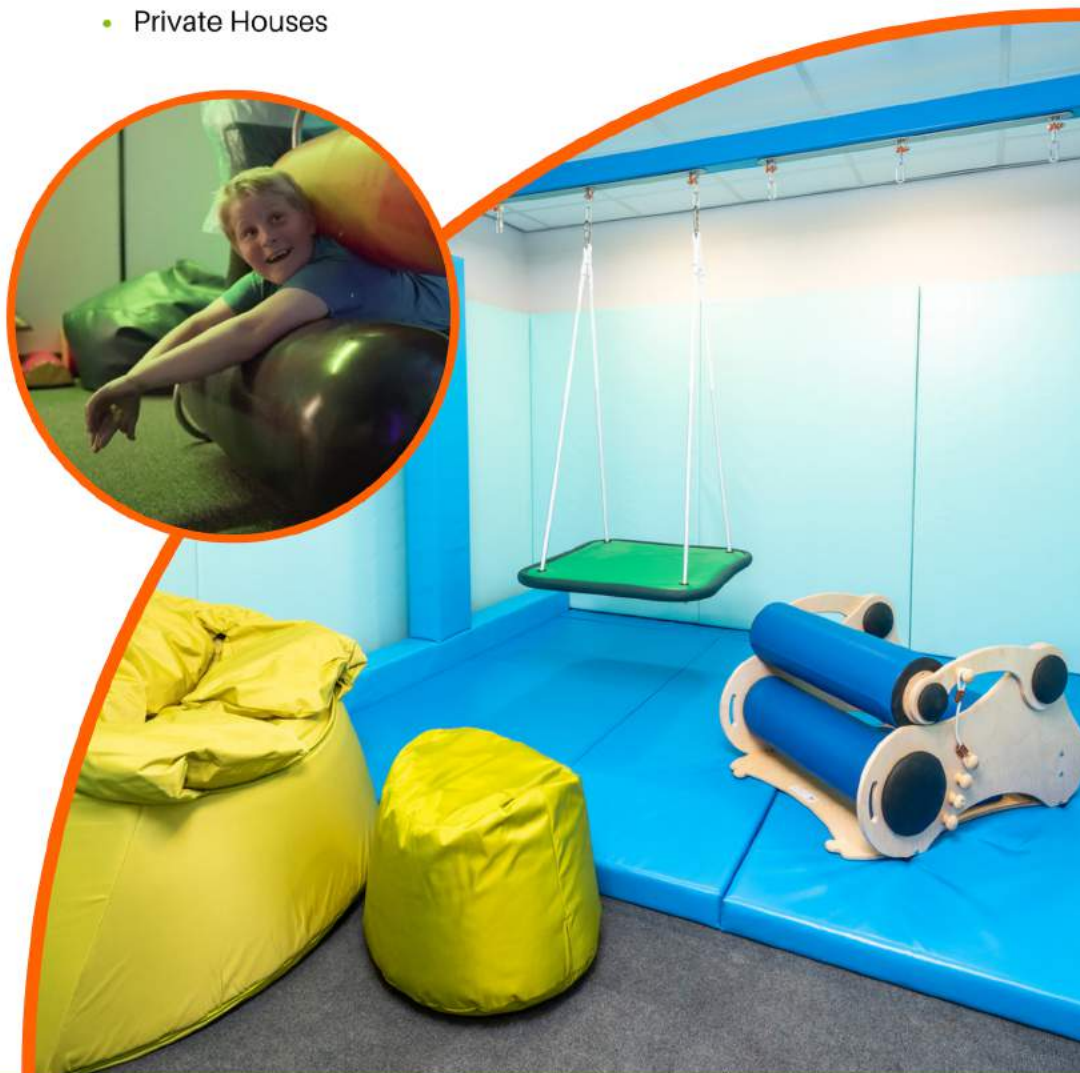

Percy Hedley School



Kisharon School

More Rehab



Our Sensory Rooms Immersive Reality

Dive into the deepest depths of the ocean or rocket into star-filled galaxies, as stunning interactive projector effects, surround sound and aromas, transform your room into an immersive multi-sensory experience.

Our Immersive Rooms are easy to use, customise and control. They are a perfect alternative to a classroom environment, inclusive of all and especially those with special needs and disabilities.

Popular Immersive Reality Room Products

Wall Projection



Floor Projection



LED Wall Wash



Cosy Seating



Benefits of Immersive Reality Rooms

- Accessible and alternative learning environment for all ages and abilities
- Improves communication and social skills
- Stimulates visual, motor and auditory senses
- Boosts focus, concentration and engagement
- Supports mental health and wellbeing

Where do Immersive Reality Rooms work best?

- Schools
- Community Centres
- Public Spaces - Museums, Leisure Centres, Football Clubs

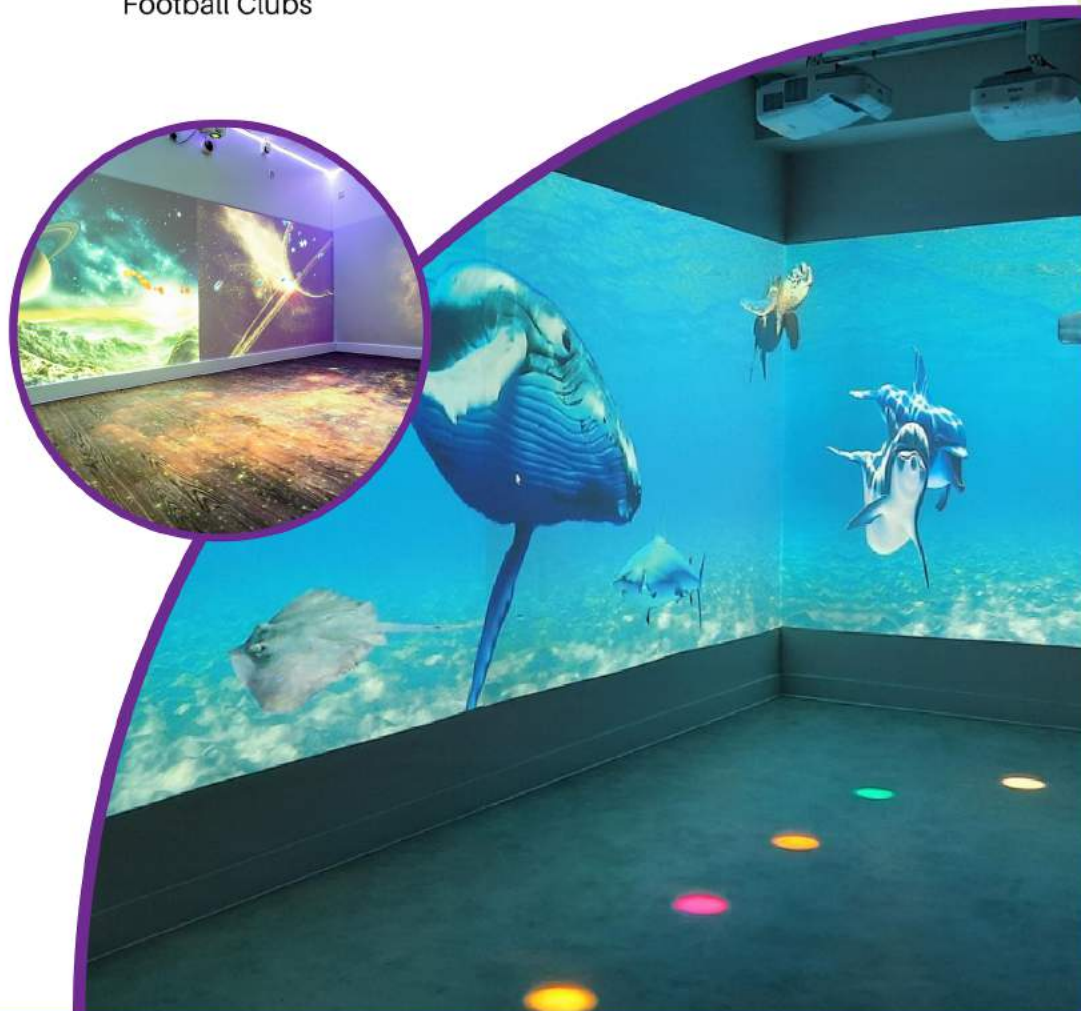

St Cripsin's School

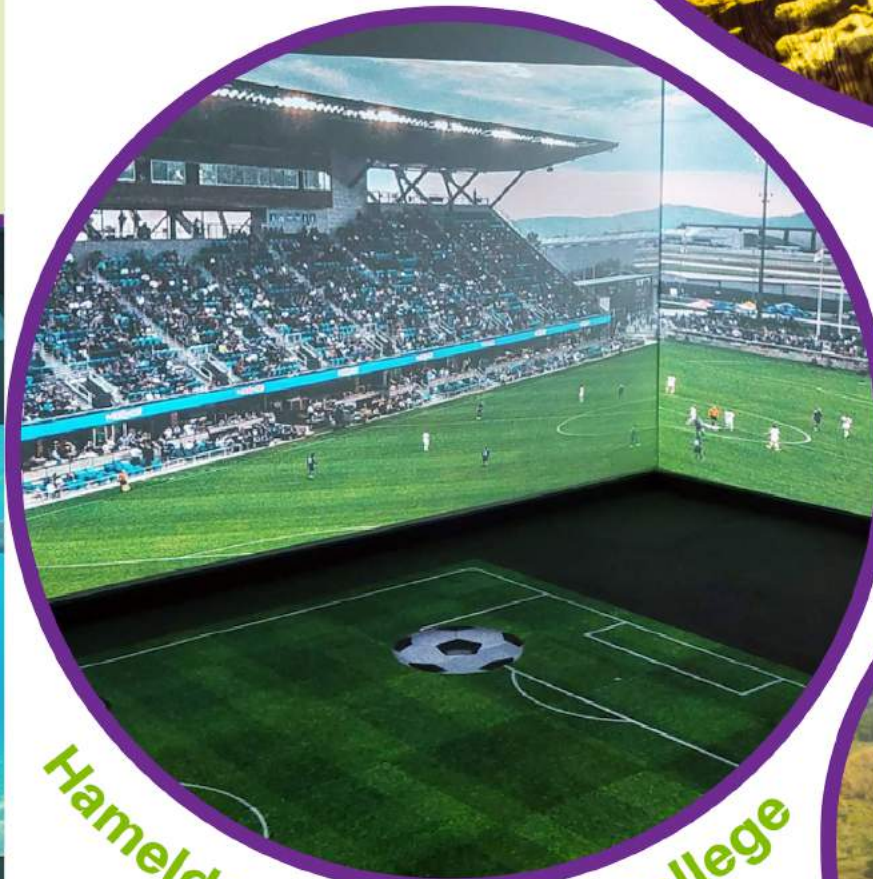

Hameldon Community College



Immersive Room

Our Sensory Rooms De-escalation

De-escalation Rooms are quiet environments that provide low levels of stimulation, enabling users to rebalance their senses, dispel anxiety and calm down. These spaces are particularly helpful for people with Autism, Learning Difficulties and Mental Illnesses.

Our therapeutic De-escalation Rooms are designed to calm, comfort and stabilise moods. They typically include soft floor and wall safety padding, a hiding den, bench seating, mood lighting, and distracting sensory ceiling effects.

Popular De-escalation Room Products

Safety Padding



LED Sky Ceiling



Therapy Chair



Bubble Wall

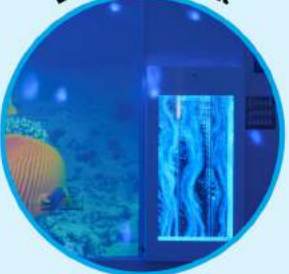

Benefits of De-escalation Rooms

- Prevents the need for restraint and seclusion
- Encourages self-regulation and control
- Reduces the possibility of a crisis situation
- Adaptable and accessible of different sensory needs

Where do De-escalation Rooms work best?

- Schools
- Mental Health Centres
- Private Houses
- Care Homes



Beacon Centre



Private Home

Calming Den



Our Sensory Rooms

Soft Play

Soft Play Rooms are exciting safe spaces for tumbling, rolling, climbing, bouncing, letting off steam, and having fun! Soft padding and interesting obstacles, such as slides, swings, and steps, provide an exploratory playground that's perfect for developing gross motor skills and bodily awareness.

All of our soft play products are made from strong, durable, and smooth touch vinyl that's double stitched for strength and durability.

Popular Soft Play Room Products

Platform, Tunnel & Slide



Ball Pool

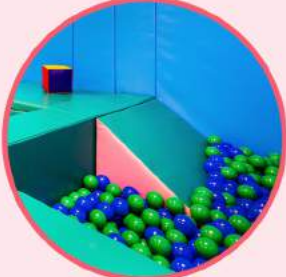

Vibrating Bumpers



Safety Padding



Benefits of Soft Play Rooms

- Motivates movement and the use of gross motor skills
- Develops essential life skills
- Encourages social interaction and group play
- Increases self-esteem and self-confidence

Where do Multi-Sensory Rooms work best?

- Schools
- Community Centres
- Public Spaces - Airports, Leisure Centres, Shopping Centres, Football Clubs
- Hospitals

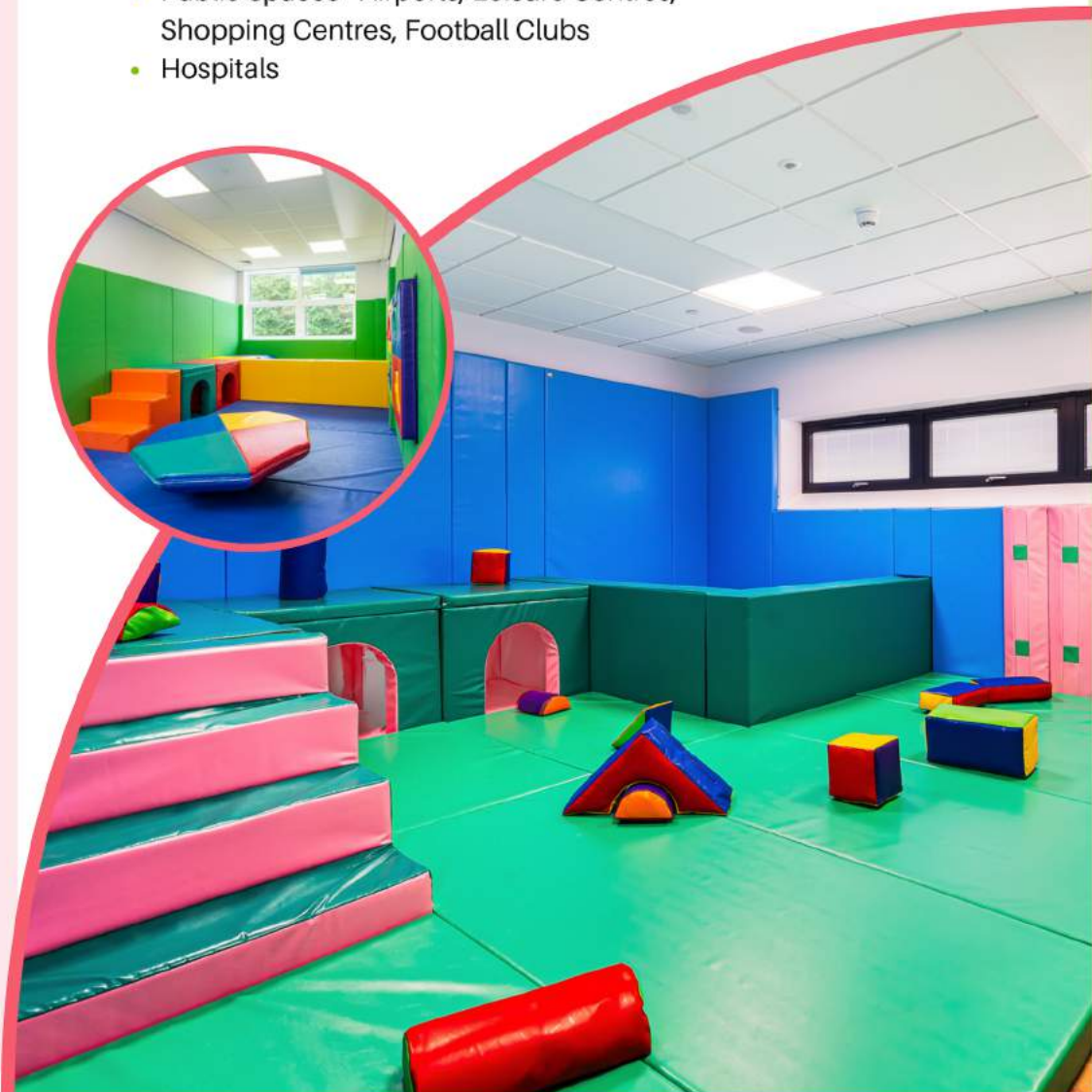

Side By Side School



Robert Ogden School

Jake's Play World



Our Sensory Rooms Safety Padding

Floor and wall padding can make any space safe. Removing the worry of nasty bumps and bruises, and creating a safe environment for users to release energy and explore their senses.

Tailor-made by our sensory team, our safety padding is a soft and protective addition for any sensory room, soft play room, bedroom, corridor or bathroom. Timber-backed, machine sewn and made to measure, we will ensure our foam padding fits your space perfectly.

Popular Safety Padding Areas

Walls



Floors



Radiators



Doors



Benefits of Safety Padding

- Can make any space safe
- Effective at reducing the amount of self-harm incidents including headbanging
- Reduces the possibility of a crisis situation

Where does Safety Padding work best?

- Sensory Rooms
- Bedrooms
- Social Areas
- Corridors

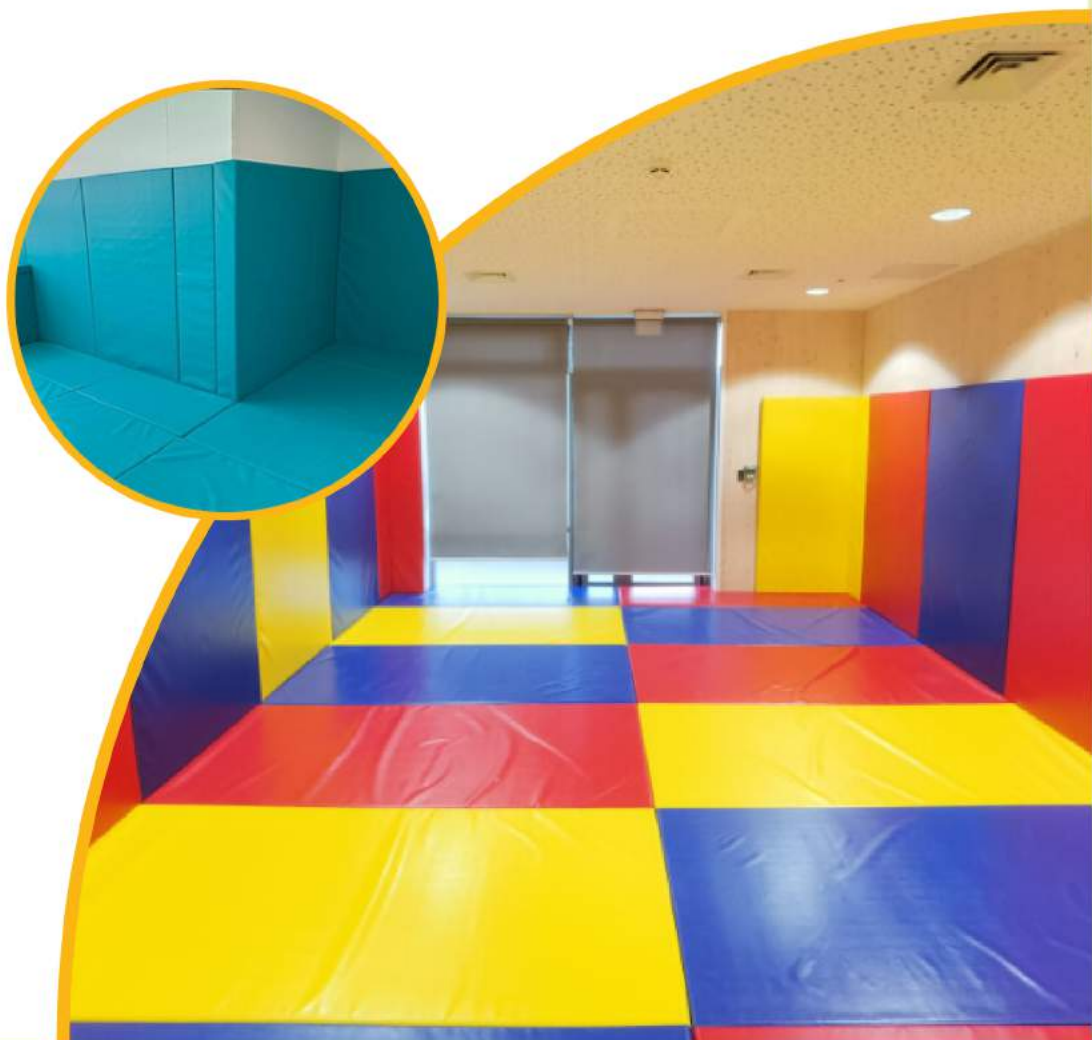

Oakwood School

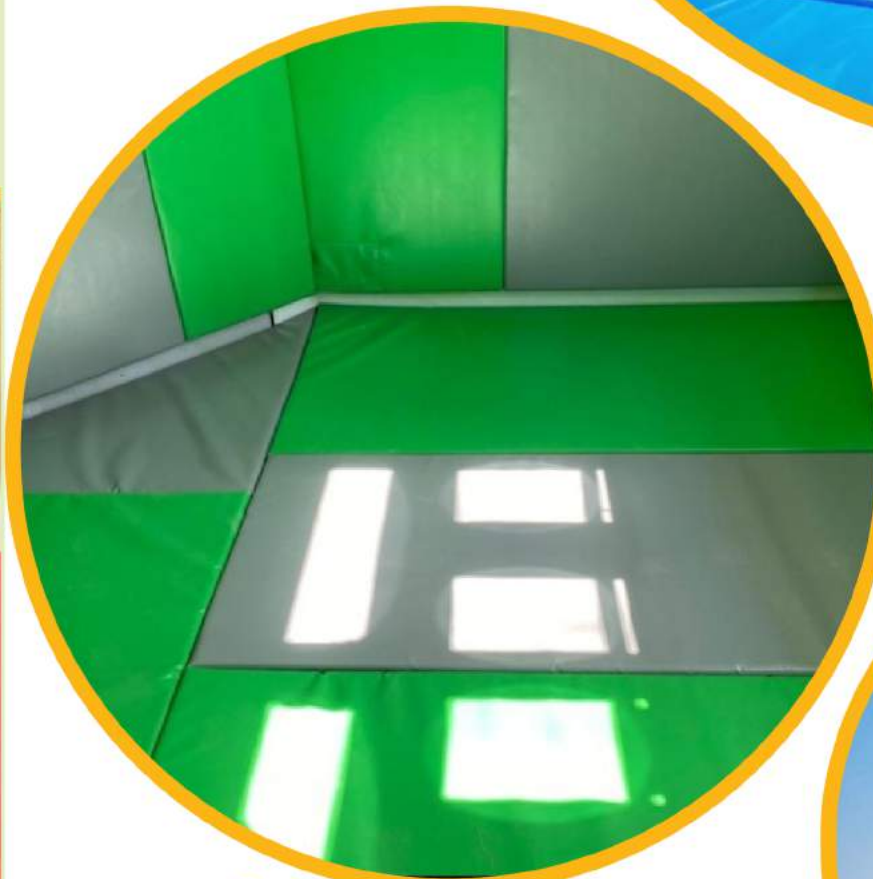

Surrey Square

Themed Padding



Rhino UK Design & Install Guide

Creating a sensory room takes time, expertise, and organisation - **which is why we're here to help!**

Years of sensory design experience have led us to create our tried and tested **6-Step Sensory Room Process**. Supporting you through your sensory room journey.



1. Design Consultation

Start your journey by booking in your free design consultation; remote or on-site.

After seeing your space, we will then sit down to discuss what you imagine your sensory room looking like.

Our friendly sensory room consultants will provide inspiration and expert advice on how they'll be able to transform your space into your sensory vision.



2. Room Design & Costs

After your consultation, we'll head back to our studio and craft your bespoke room design proposal, which will include:

- Full 3D visuals to bring your design to life
- An equipment cost breakdown
- Recommended room preparations



3. Design Review Meeting

We'll sit down together over a Teams meeting to discuss your design proposal.

This 30-minute meeting gives you the opportunity to collaborate closely with our sensory teams to ensure your room design works for your space, needs and budget.

After this meeting, and with your confirmation, we'll be able to fast track your sensory room install.



4. Design Approval

With decisions made and designs signed off it's time to choose your finishing touches, colours, prints and more! Your assigned project manager will talk you through your final decisions, and the preparations that will need to be made before install.

If needed, we can collaborate with contractors and architects to refine your room, build, and specification to make a perfect sensory space.

5. Installation

We do our best to organise installs around your schedule and deadlines. And we'll aim to minimise disturbances, as our experienced fitters install your sensory room with ease and precision.

All of our fitters hold CSCS cards and DBS Certificates for ultimate client protection. Works are carried out in full accordance with all British Standards and Health & Safety requirements.

6. Handover & Training

Now that your room is complete and ready to use, it's time to get familiar with how it works.

One of our sensory specialists will be onsite to handover your room, talking you and your colleagues through the room's features and how to use them.

7. Maintenance Packages

All of our sensory installations come with 12 Months warranty and a lifetime of telephone support.

Or if you'd like extra security, you could consider one of our personalised Jungle Care Maintenance Packages that offer extended warranty and room cleaning services.

Sensory Room Maintenance Options

We want to make sure you get the most out of your new sensory space. With regular inspections, **maintenance**, and a bit of tender loving care, your multi-sensory equipment will remain in good working order for a very long time.

Upon installation, we'll pass on our **expert advice** on the use, care and cleaning of all your sensory equipment so that you can become sensory sages of your new space.

And alongside that, you'll also receive **12 months warranty on each item and a lifetime of telephone support** for any additional advice you may need.

Jungle Care Packages

If you'd like extra Sensory Room support, one of our Jungle Care Maintenance Packages could be what you're looking for.

From our basic **Valdivian package** that extends your yearly warranty. To deluxe **Amazon packages** that include on-site support and regular maintenance visits. Take care of your sensory space in a way that works for you.

Our Jungle Care Packages can be taken out at any point in your sensory journey, although we'd recommend you do at the start so that you don't have to worry about it later.



Valdivian

- Jungle Care Kit
- Annual Service
- Maintenance and Sanitising Visit
- Extended 12 Month Warranty



Congo

- Three On-Site Support Visits
- Annual Water Treatments
- Room Component Repair Service



Amazon

- Unlimited On-Site Support Visits
- Quarterly Water Treatments
- Room Component Repair Service

Valdivian



Congo



Amazon



Care Kit

When you buy a Jungle Care Package you'll receive a Jungle Clean Care Kit, which includes; tools, cleaning supplies and accessories to keep your equipment as good as new.

Annual System Service

Our annual system services include:

- A deep clean & sanitisation
- Equipment check
- Maintenance works

(This will be provided 12 months after original installation or 3 months after cover is purchased).

Extended Warranty

12 months after your Annual System Service.

Telephone Support

Our sensory experts are always on hand to provide support & advice over the phone.

On-Site Support

We'll provide an on-site engineer to repair or replace faulty components at an agreed time and within 7 days of contact. (Subject to availability of parts from suppliers).

Water Changes

We'll clean & treat the water in Bubble Tubes & Waterbeds.

Room Component Repair Service

Components excluded from cover:

- Bulbs
- Consumable Parts
- Breakages due to misuse

*Terms & Conditions Apply



Max 3 visits a year



Unlimited



Bubble Tube water needs changing every 6 weeks



During annual visit



Quarterly



On-site removal and return of faulty equipment including installation when necessary.



On-site removal and return of faulty equipment including installation when necessary.

Sensory Room FAQs

If you've got a question about anything included in this pack, your quotation, or anything to do with your sensory room, make sure you **get in touch** with a member of our friendly sensory team - they'll be more than happy to help!

We've answered some of our most popular questions below. Hopefully, it'll save you a phone call.



How much is an installation project likely to cost?

A classic sensory room project starts at around £5,000.

Discover how much your dream sensory room might cost using our Cost Calculator on our website. www.rhinouk.com/cost-calculator/



Is there a cost for a sensory room design?

No. All of our designs are completely free of charge!

And we're happy to make as many changes and alterations until the design is completely right for you, your needs and budget.



How do I know which sensory equipment to choose?

Before each sensory project, our sensory specialists will sit down with you to discuss your needs, space and budget. From there they'll be able to recommend the best sensory resources for you.



How do I use the sensory equipment?

Every sensory installation is completed with a room handover, where we'll give you a full explainer of all of the room's elements and how you can use them to their full advantage.

And if you ever need any advice, we're always just a quick phone call away!



Can you help me fundraise for Sensory Equipment?

Yes! We have a free-to-download fundraising pack filled with information about grants, loans and fundraising ideas available to you.

Discover our funding page www.rhinouk.com/sensory-room-funding/



How do I know what electricals the room needs?

Complete electrical plans are provided with each room design.

When it comes to installation, we have our own team of electricians, but if you'd like to use your own for the project that's not a problem.